



FACILITIES AND TECHNOLOGY

THE COVENANT SCHOOL

2024-2025



INTRODUCTIONS

- Facilities Team
 - Erasmo (aka Raz) – Day Porter
 - Ophelia – Day Porter
 - Mike Cano – Facilities Technician
 - Mason Smith – Facilities Director



HELPDESK IS YOUR FRIEND

- Helpdesk -
covenantdallas.freshdesk.com/support/login
 - Select login with Google
 - Facilities – help tickets, no room reservation and set-up requests
 - Technology – requests
- Event Requests and Set-ups
- Emergencies – Dial “0” for Debbie Paul, Office Manager



JANITORIAL SERVICES

- Contractor: Total Business Maintenance (TBM)
- Schedule: Five nights a week, Sunday through Thursday
- Services:
 - Floor vacuumed or swept and mopped
 - Trash emptied
 - Restrooms cleaned and restocked
 - Dust open surfaces
- Recycle
 - Products (paper and cardboard – no plastic)
 - Locations (you empty from room to recycle bin)



CLOSING YOUR CLASSROOM

- Blinds closed
- Electric items off
- Thermostat set at 75 (summer), 68 winter
- Turn lights off
- Lock door



TECHNOLOGY

- Technology Staff
 - Technology Director – Mike Jobes
 - Technology Assistant – Dan Stewart
- Computer / Laptop
 - All full time faculty and staff will be issued a Windows based laptop
 - Windows Updates
- Wi-Fi
 - Knights: School owned devices
 - Knights.BYOD: Personal devices - Hebrews13#21
 - Guest: Visitors to Covenant - 1Peter4:9-0724
- Passwords
 - Passwords should be changed regularly, forced changes twice a year
 - Passwords can be changed anytime by pressing Ctrl-Alt-Delete and selecting “Change a password”
 - Password can only be changed from your school issued laptop / while on campus
 - 2 factor passwords requirement for Google and Gmail.

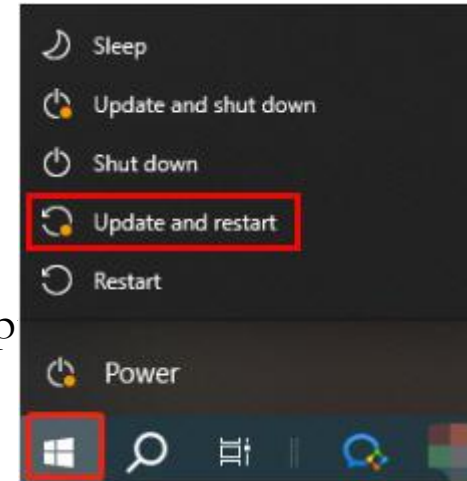



TECHNOLOGY

- Email and Applications

- Covenant Email / GMail
- Google Suite / Microsoft Office

- Data Storage

- Google Drive
- Google Shared Drives
- Fileserver
 - H: Your personal “Home” drive – Sync’ed with your Documents Folder and is available offline
 - K: A shared data drive “Knights”
 - Some departments have a departmental drive F: = Fine Arts, etc.

- Printers

- Ton’s of shared departmental printers
- Personal Printers – Not Supported



TECHNOLOGY

- Sync Google Chrome

- Bookmarks, saved passwords, other profile settings are synced across all of your devices
- Access to the Covenant Homepage and Staff Bookmarks
- <https://support.google.com/chrome/answer/185277>
- <https://www.youtube.com/watch?v=j92XtFs-iuI>

The image displays two screenshots from a mobile device showing Google Chrome's sync and profile management interface. Red boxes and arrows highlight specific steps for enabling sync and adding profiles.

Left Screenshot (Chrome Sync Setup):

- Click the Chrome Profile Icon:** Points to the profile icon in the top right corner of the browser.
- Click Turn on sync and follow the steps:** Points to the "Turn on sync..." button in the "Sync and personalize Chrome across your devices" section.
- If you see this message go ahead and check the box:** Points to the checkbox labeled "Add existing browsing data to managed profile" at the bottom.

Right Screenshot (Profile Management):

- Click Add to add additional profiles:** Points to the "+ Add" button at the bottom of the "Other profiles" list.

Other profiles list (from right screenshot):

- Cov.Adm (covenantdallas.com)
- Michael (JobesTech)
- Sys Admin (covenantdallas.com)
- Test (covenantdallas.com)
- Guest
- + Add



TECHNOLOGY

- Calendars

- Staff Bookmarks
- Divisional Calendars, etc.

- Classroom

- Projector and document camera
- Wireless Screen Casting
- Speakers and audio system
- Mouse, keyboard and monitor provided, as needed

- Audio / Video

- Common Spaces: The Commons, The Attic, Covenant Hall, Press Box
- Request Use - Brightly

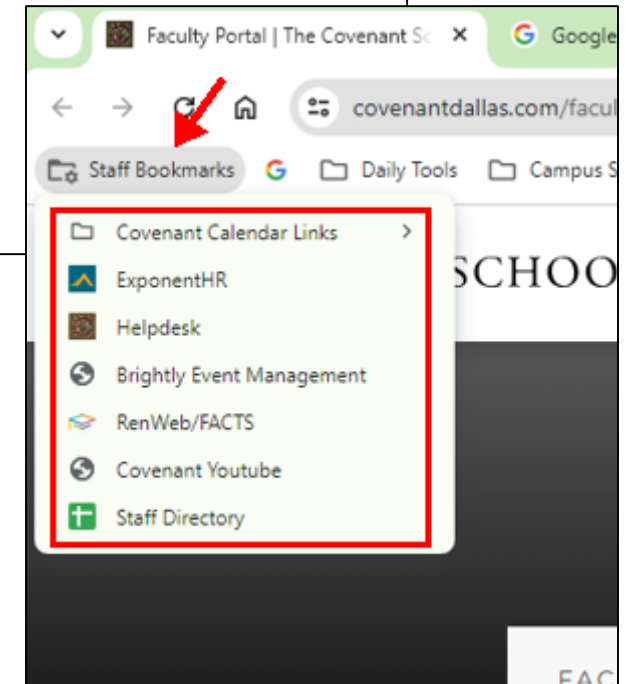
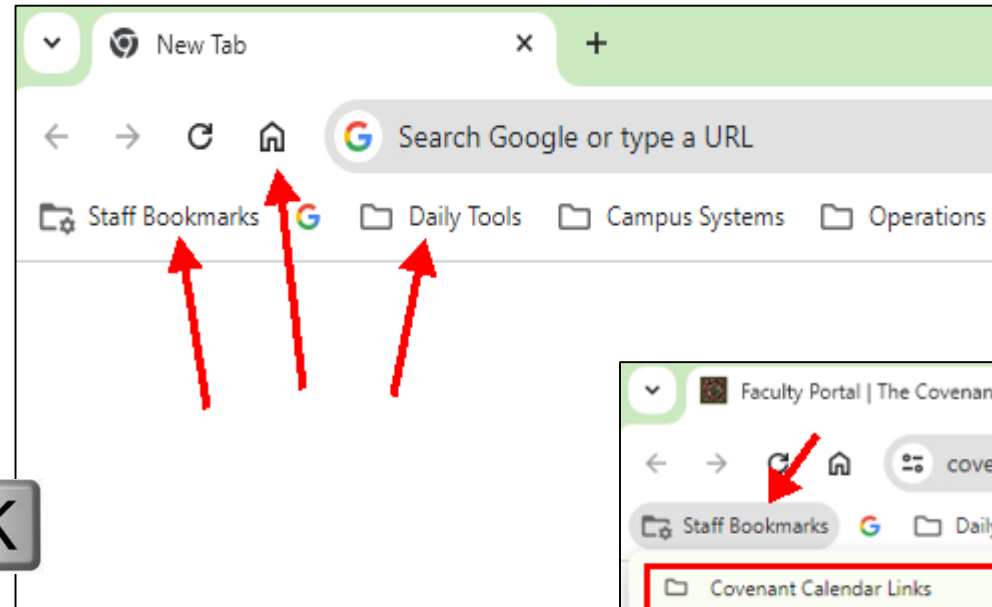



TECHNOLOGY

- Cyber Security

- Antivirus / Antimalware - Malwarebytes (enterprises)
- Browser guard - Malwarebytes Browser Guard (Chrome extension)
- Lightspeed Relay - Web filter / YouTube Filter
- Override or send me a picture of the message you get (may look different)

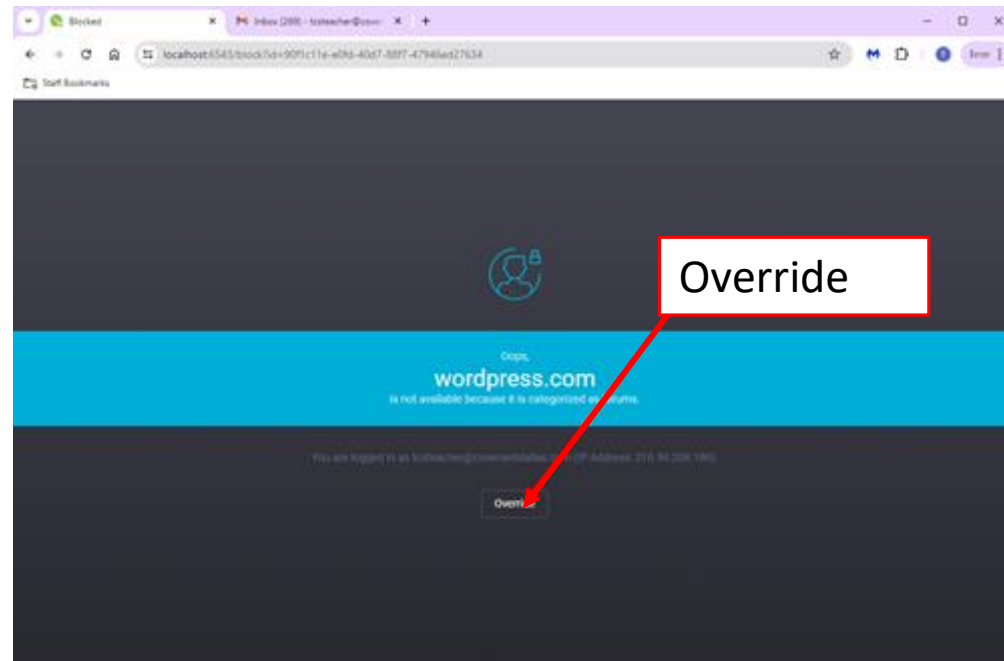

Web Filter



TECHNOLOGY

YouTube Filter

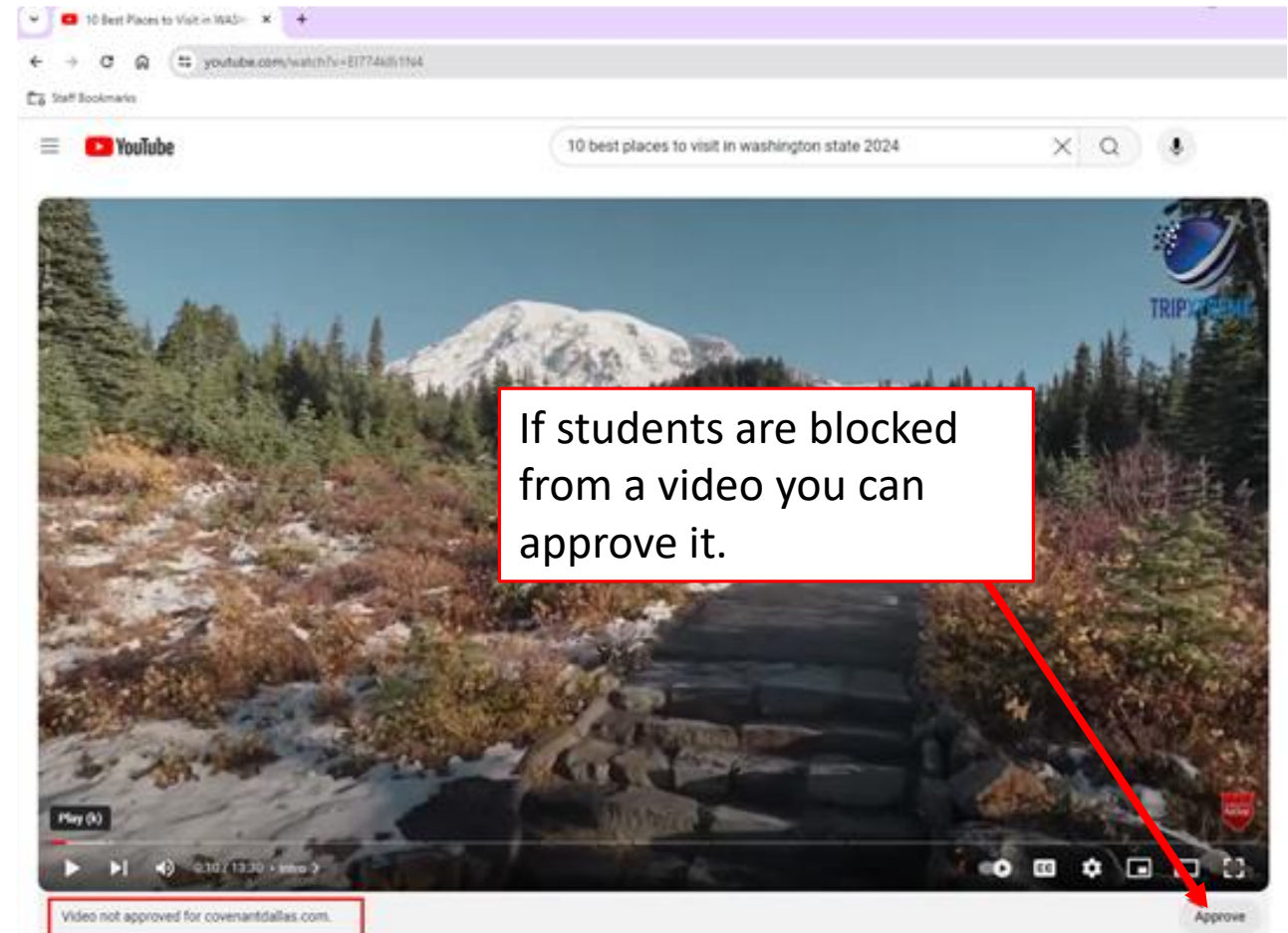
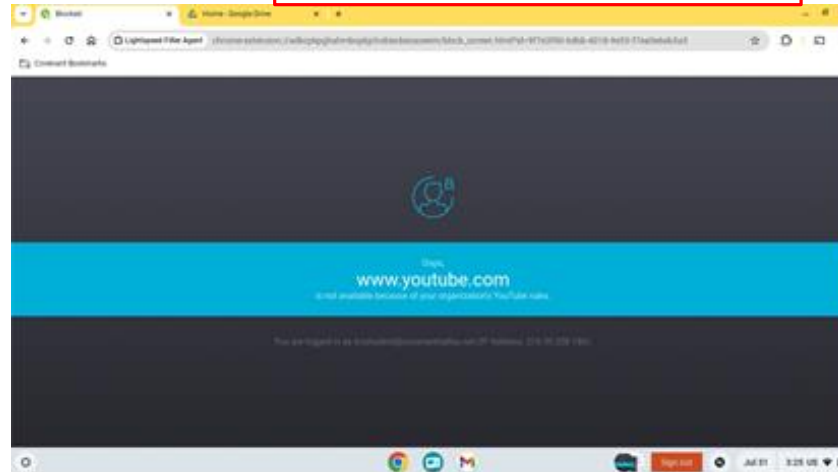
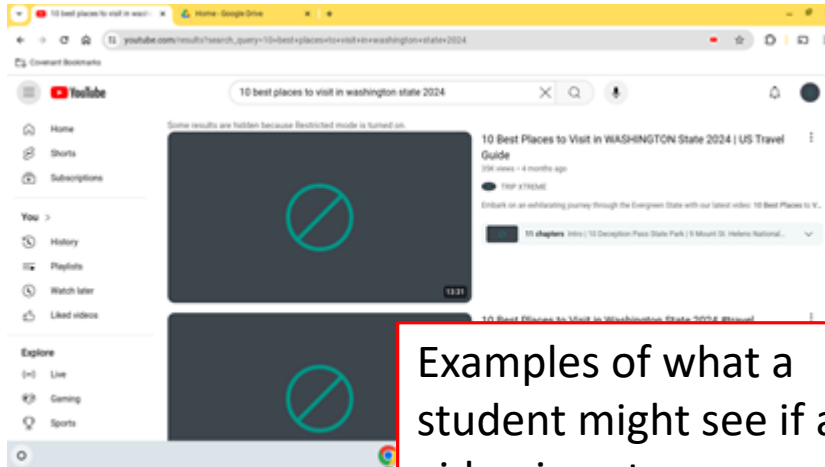



TECHNOLOGY

Updates / Restart

When you see the orange dot
Windows has some updates
that need to be applied

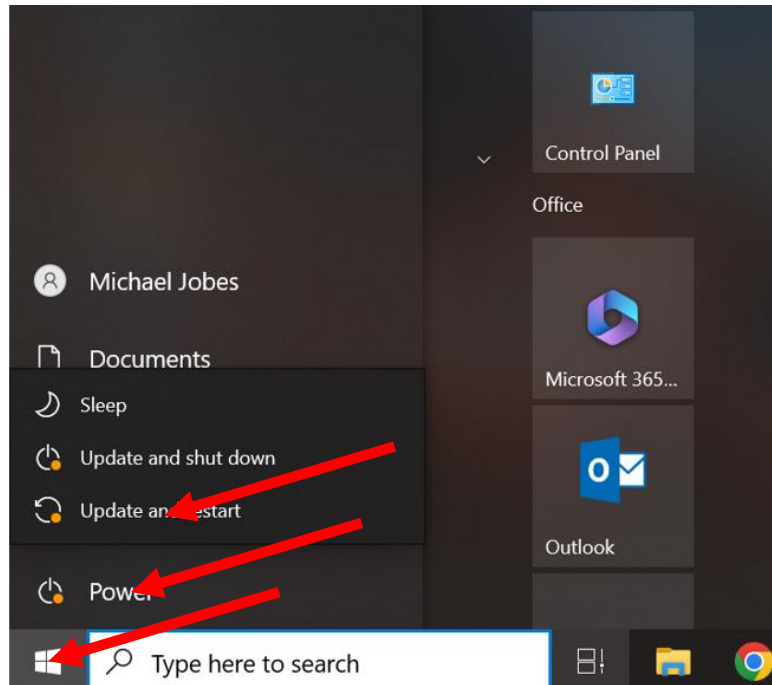

From time to time it is important
to restart to laptop... Especially if
it seems to be running slow

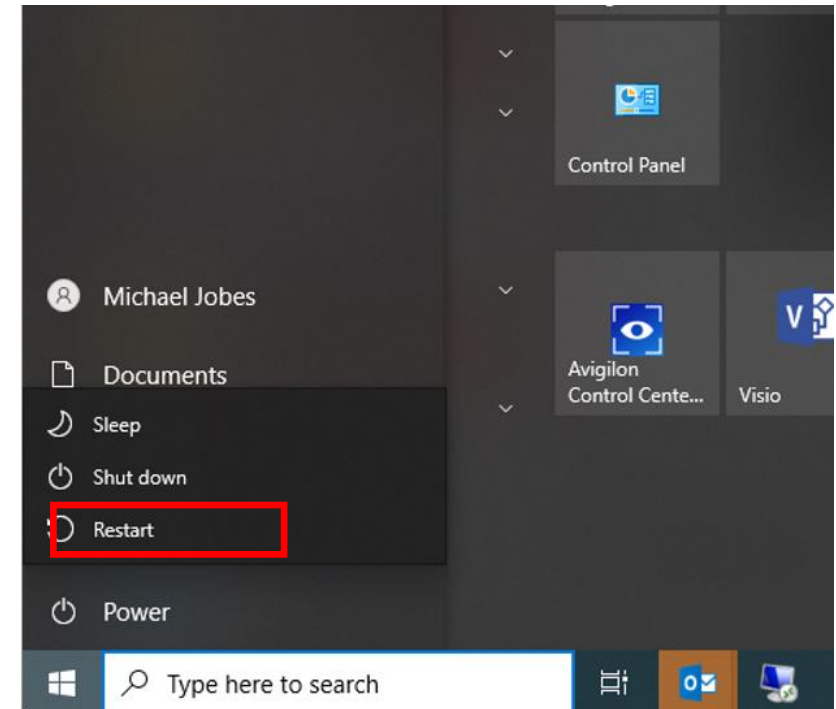



TECHNOLOGY

Front Gate / Access Control

Toll Tag

- Register Toll Tag(s) in ExponentHR
- Teachers and Staff 24x7 access
- Students and Parents 7:00am (6:30) – 9:00pm
- Faculty and staff can use access fob at front gate 24x7
- 24x7 Fob Access to Logic Hall, Rhetoric Hall, Commons and Carson Leslie Center



TECHNOLOGY

Front Gate / Access Control

Toll Tag





FACILITIES AND TECHNOLOGY

QUESTIONS

One last helpdesk mention

<https://covenantdallas.freshdesk.com/support/login>